

Waterproof Flood Light

Model: LD706-54039F

Power Version

USER'S MANUAL

This product manual contains important information about safe installation and use of this product. Please read and follow this instruction carefully.

Update:2017.12.09



1 Understanding of Product

1.1 Security Warning

- ❖ When unpacking and before disposing of the carton, check if there is any transportation damage before using the product. Should there be any damage caused by transportation, consult your dealer and do not use the apparatus.
- ❖ This product is suitable for indoor and outdoor, its protection grade is IP65.
- ❖ Do not install the product or project the beam onto inflammable surfaces. Minimum distance is 5 M
D 5M
- ❖ The product is only intended for installation, operation and maintenance by qualified personnel. And read the user manual and labels on the lighting carefully before use.
- ❖ Product should install in a cool place. Keep away from the wall 50cm.
- ❖ Do not look directly at the lamp light (especially for epilepsy), so as not to cause damage to the eyes.
- ❖ Keep the optical system clean. Do not touch the LED lens with bare hands. Do not use any alcohol liquid or any other liquid to clean the optical system. Use medicinal absorbent cotton to clean it.
- ❖ Please do not attempt to dismantle and/or modify the product inner structure. Otherwise, would not provide 1 year of free warranty.
- ❖ Electrical connection must only be carried out by qualified personnel.
- ❖ Before installation, ensure that the voltage and frequency of power supply match the power requirement of the product.
- ❖ It is essential that each product is correctly earthed and that electrical installation conforms to all relevant standards.
- ❖ Do not connect this device to any other types of dimmer apparatus.
- ❖ Make sure that the power-cord is never crimped or damaged by sharp edges. Never let the power-cord come into contact with other cables. Only handle the power-cord by the plug. Never pull out the plug by tugging the power-cord.
- ❖ There is no user serviceable parts inside the product, do not open the housing and never operate the product with the cover removed.
- ❖ Place the unit where kids can't reach.

If you have any questions, don't hesitate to consult our dealer or manufacturer.

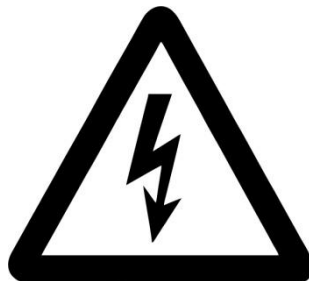

Important: Before any installation, maintenance and cleaning, please ensure that the power cuts off!

1.2 Main Technical Parameters

Power supply

- Rated Voltage: AC90~120V
- Rated Frequency: 50~60Hz $\pm 10\%$
- Rated Power: 200W

LED

- LED Type: 54pcs x3W RGB 3in1 LED Chips
- Drive Current: 700mA
- Lifespan: About 50000 hours

Control

- Control Protocol: International standard DMX-512 signal
- Channel mode: 3Chs
- Control mode: DMX-512, auto-program mode, master-slave mode, static mode and LED display
- Auto effect: 3 kinds auto effects

Optical System

- Beam angle: 60°
- Lens: Curved high efficient reflector cup

Physical

- Dimensions: 360 x 221 x 266mm
- Weight: 8.8kg
- Surface Treatment: Aluminum, powder coating
- Housing color: Black
- Connection: Signal cable IN/OUT, power cable IN/OUT.

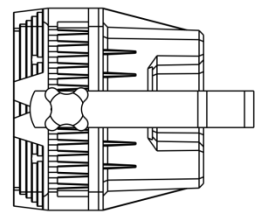
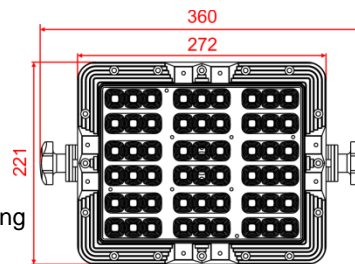

Security

- Cooling System: Convection
- Temperature Protection: 65°C
- IP grade: IP65
- Operating Environment: Outdoor and indoor
- Working Temperature: -20°C~40°C

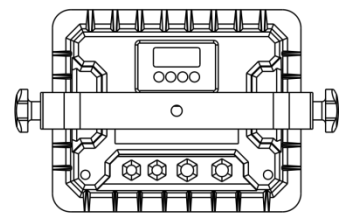
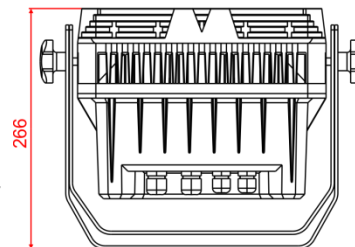

1.3 Product Features

Using the latest LED control technique, newest intelligent LED Par light can realize intelligent operation and control through its special menu at the side of the body. It's more convenient and easy to operate. This product is designed for building large area spread light, large concerts, outdoor landscape lighting, wedding scene, small performances, slow club KTV and various performance occasion. Its main features include:

- 1) Static color Settings (STATIC).
- 2) 3K high refresh rate, no dark streaks when shooting.
- 3) The static power consumption of the control panel is 0.3W, and its efficiency will reach up to 97%.
- 4) Smooth color mix and high brightness by using latest curved high efficient reflective cup lens.
- 5) Intelligent master slave control can detect master or slave signal.
- 6) Linear dimming.
- 7) Inbuilt multi auto effects.
- 8) Overheating automatic protection function (lower working current).
- 9) LED display screen.
- 10) Password-protected keyboard
- 11) 3 kinds DMX working mode.
- 12) Master-slave control, multi-units for synchronous control.

1.4 Product Packing Information

Following accessories are packed together with the product, please check them carefully upon unpacking.

Item	QTY	unit	Remark
LD706 LED Waterproof Flood Light	1	pc	
LD706 LED Waterproof Flood Light Hanger	2	pcs	Installed
Hanger Screw	2	pcs	Installed
Instruction Manual	1	pc	
Signal Cable	1	pc	Installed
Power Cable	1	pc	Installed

2 Product Installation

2.1 Power Connection Method

Please connect power as following :

L (live wire) =brown wire

E (earth wire) =yellow/green double color wire

N (null line) =blue wire

When connecting power, ensure that the voltage and frequency of power supply match the power requirement of the product.

This equipment belong to class 1 protection equipment, therefore, the yellow-green double colors wire must be earthed correctly by qualified personnel. Before installation, ensure that the voltage and frequency of power supply match the power requirements of product. In power supply and voltage fluctuation large areas, we suggest you to use 110V or 230V or use voltage regulator to supply power.

After electrical connection, this product will have a few seconds self-check action, self-check finished can be used.

Input / output power cable should be 2.5 square millimeter copper core.

220V: 15 units may be connected in series.

110V: 7 units may be connected in series.

Important: It is essential that Yellow/green double color wire is correctly earthed and that electrical installation conforms to all relevant standards.

2.2 DMX Connection Method

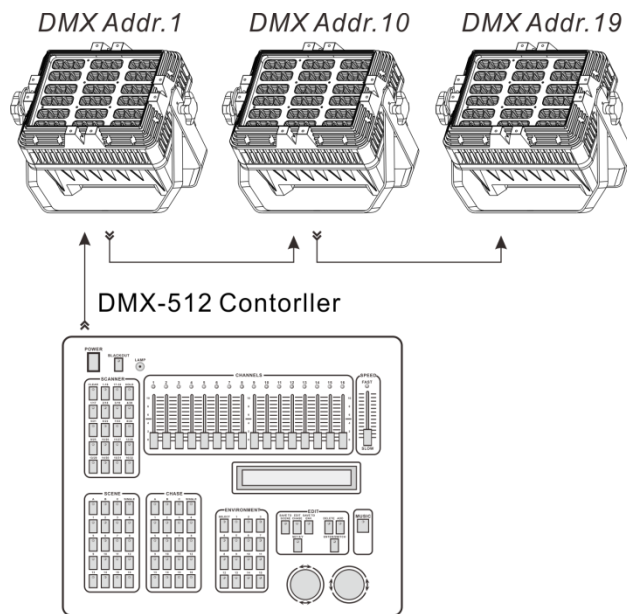

- ❖ The DMX interface of lamp needs be connected to the DMX controller.
- ❖ Since STAG MODE has 9 channels, the address code with 9 increment increasing progressively (e.g., 1, 10, 19, 28...).
- ❖ Every DMX address code can be reused as needed.
- ❖ DMX address code can be any data between 001 and 512.

Note: 1. As this fixture's DMX signal cable connection is parallel connection, please don't connect more than 15 units.
2. If the signal cable is over 60m between the DMX512 controller and fixture or between two fixtures, then a DMX signal amplifier is needed.

3 Operation Method

3.1 Menu Overview

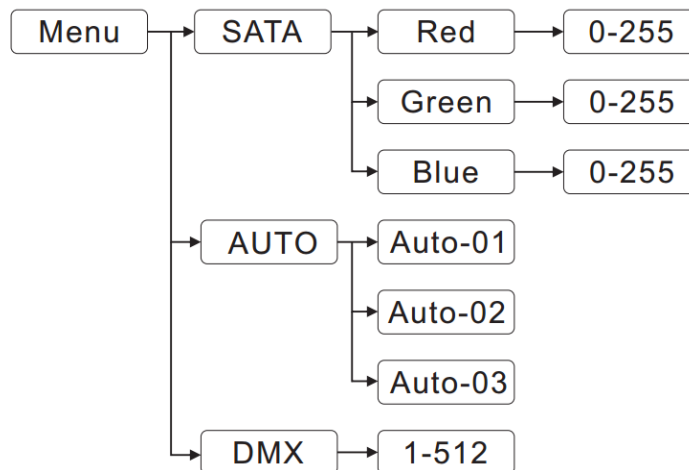

3.2 Static Color Setting (STATIC)

- Find **【STATIC】** menu and press **【ENTER】** to enter color static setting.
- Press **【ENTER】** button to select **【RED】** , **【GREEN】** , **【BLUE】**
- Press **【UP/DOWN】** button to adjust parameters.
- Press **【MENU】** button to return to the menu, the selected parameters will be automatically saved.
- After setting lighting fixture's static color, restart the lighting fixture's power supply. The setting was preserved. Exit menu, static color setting will be removed.

Note: When entered this submenu, the light fixture will automatically set to the data status sent by the master, other light fixtures should be set as the slave. Then, any other master lighting fixtures must be disconnected, as well as the DMX signal cables. Otherwise it will cause disordering.

3.3 Automatic Programming Setting (AUTO)

- Find **【AUTO】** menu and press **【ENTER】** to enter automatic programming setting.
- Press **【UP/DOWN】** button to select **【AT.01~03】** 5 kinds of auto-program. Press **【ENTER】** to confirm your setting.
- After setting lighting fixture's automatic operation, restart the lighting fixture's power supply. The setting was preserved. Exit menu, automatic operation setting will be removed.

Note: When entered this submenu, the light fixture will automatically set to the data status sent by the master, other light fixtures should be set as the slave. Then, any other master lighting fixtures must be disconnected, as well as the DMX signal cables. Otherwise it will cause disordering.

3.4 DMX Code Setting (DMX)

- Find **【DMX】** menu and press **【ENTER】** to enter address code setting.
- ❖ Press **【UP/DOWN】** button to select DMX address code.
- ❖ Press **【ENTER】** to confirm or **【MENU】** to exit, the selected address code will be automatically saved.

3.5 Temperature Control Protection State

- When the temperature of the LED bead plate more than 65°C, the light fixture begin slowly to reduce the working current, to protect the LED lamp bead is not damaged by high temperature heat aging.
- When the temperature of the LED bead plate lower than 65°C, the light fixture begin slowly to rise working current, until restore to the normal working current.

4 Control Channel

4.1 3CH Channel Mode

CH	DMX data	Function	Description
1	0 ↔ 255	Red Dimmer	Brightness 0~100%
2	0 ↔ 255	Green Dimmer	
3	0 ↔ 255	Blue Dimmer	

5 Maintenance

5.1 Product Maintenance

To prolong the life of the product, it is very important to do maintenance work. The environment is harsh outdoors, or if the product is idle for a long time, damp, smoke or particularly dirty surroundings can cause greater accumulation of dirt on its LED lens cover, fan vents and housing. So it should be cleaned to maintain an optimum light output and at the same time to prevent it from corrupted by acid gas.

Cleaning frequency depends on the environment in which the fixture operates. Soft cloth and typical glass cleaning products should be used for cleaning. It is recommended to clean product at least one every 20 days.

Friendly notice: Please do not use any organic solvent, e.g. alcohol to clean housing of the apparatus, lest cause damage.

5.2 Trouble Shooting

Problems	Action
The product doesn't switch on	Power connection is not correct--Re-connect it.
	Power supply is damaged or abnormal. Call a qualified personnel to fix it.
	Control section is damaged. Call a qualified personnel to fix it.
	Connection of internal circuitry is not correct. Call a qualified personnel to fix it.
The product can turn on, but LEDs do not emit light and are out of control	DMX address is wrongly setting up. Resetting it according to instruction book.
	DMX Signal wrongly connected. Connect it correctly according to instruction book.
	Control section is damaged. Call a qualified personnel to fix it.
The beam appears dim	The product is too hot. Take ventilation measures to make it cool.

Remark: This product warranty for one year. We provide pay-needed maintenance service after the warranty. But because of natural and man-made disasters or improper operation caused damage not under warranty range!